

INCORRECT
SUCTION PIPING ARRANGEMENT

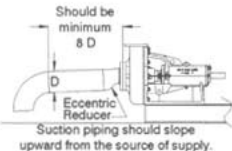

CORRECT
SUCTION PIPING ARRANGEMENT

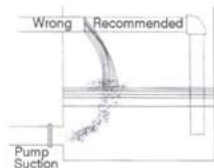

To minimize air entering fluid at the pump suction and to facilitate fluid mixing, the fluid return should be away from the suction and below the fluid level.

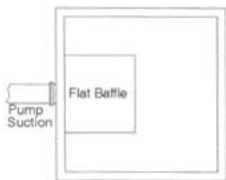

EXAMPLE 1 (Plan View)

Vortex at pump suction can be prevented by proper baffle arrangements. Two examples are shown here.

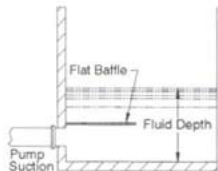

EXAMPLE 1 (Side View)

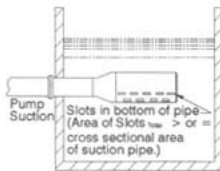

EXAMPLE 2 (Side View)